

RL20001HE

S-beam, Stainless Steel, NTEP Certified 1:5000 Class III/1:10,000 Class III Single Cell Welded-seal, IP68

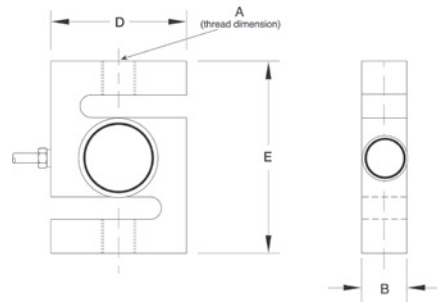

Picture is a representation of actual product



Specifications

Full Scale Output:
2.0 mV/V

Bridge Resistance:
350 ohms, nominal

Material/Finish:
Stainless steel

Safe Overload:
150% full scale

Rated Excitation:
5-10 VDC (15 V maximum)

Temperature:
Compensated range
14° F to 104° F / -10° C to 40° C
Operating range
-40° F to 150° F / -40° C to 65° C

Nonlinearity:
0.03% full scale

Hysteresis:
0.02% full scale

Insulation Resistance:
5,000 megohms

Seal Type:
Welded-seal, IP68

Cable Length:
20 ft (6.1 m)

Cable Diameter:
0.200 polyurethane jacket

Cable Color Code:
Red+ Excitation
Black.....- Excitation
Green+ Signal
White- Signal

Warranty:
Two-year limited warranty

Approvals:



Dimensions

RATED CAPACITY	A	B	D	E
lb/inches				
500-3,000	1/2-20 UNF	1.00	2.00	3.00
5000-10,000	3/4-16 UNF	1.00	3.50	4.75
kg/mm				
453.6-1,360.8	1/2-20	25.4	50.8	76.2
2,268.0-4,535.9	3/4-16	25.4	88.9	120.7

Order Information

LOAD RATING	PART #	EST. SHIPPING WEIGHT	PRICE
RL20001HE NTEP Certified			
500 lb (226.8 kg)	46469	2 lb	Consult
750 lb (340.2 kg)	46470	2 lb	Consult
1,000 lb (453.6 kg)	46471	2 lb	Consult
1,500 lb (680.4 kg)	46472	2 lb	Consult
2,000 lb (907.2 kg)	46473	2 lb	Consult
2,500 lb (1,134.0 kg)	46474	2 lb	Consult
3,000 lb (1,360.8 kg)	46475	2 lb	Consult
5,000 lb (2,268.0 kg)	46476	5 lb	Consult
RL20001 HE Non-NTEP Certified			
10,000 lb (4,535.9 kg)	36292	5 lb	Consult

Interchangeable Products

MANUFACTURER	MODEL	PAGE #
VPG Sensortronics®	60063	301

Weigh Module Available

MANUFACTURER	MODEL	PAGE #
Rice Lake Weighing Systems	ITCM Isolated Tension Cell Mount	46