

RL20000

S-beam, Alloy Steel, NTEP Certified 1:5000 III/1:10,000 IIII

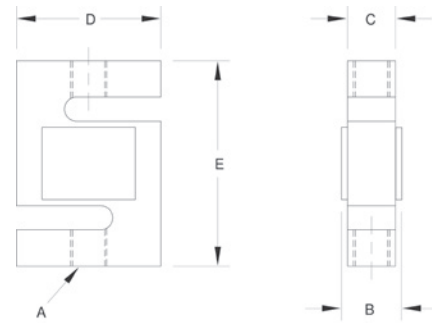

Picture is a representation of actual product



Specifications

Full Scale Output:

3.0mV/V

Output Resistance:

350 (± 3) ohms

Input Resistance:

385 (± 5) ohms

Material/Finish:

High-alloy steel, nickel plated

Temperature:

Compensated range
14° F to 104° F/-10° C to 40° C
Operating range
-40° F to 150° F/-40° C to 65° C

Seal Type:

Environmentally sealed, IP67

Safe Overload:

150% full scale

Rated Excitation:

5-10 VDC (15 V maximum)

Combined Error:

0.02%

Insulation Resistance:

5,000 megohms

Cable Length:

20 ft (6.1 m)

Cable Diameter:

0.200 polyurethane jacket

Cable Color Code:

Red+ Excitation
Black.....- Excitation
Green+ Signal
White- Signal

Warranty:

Two-year limited warranty

Approvals:



Dimensions

RATED CAPACITY	A	B	C	D	E
lb/inches					
25-300	1/4-28 UNF-2B	0.75	0.50	2.00	2.50
500-1,500	1/2-20 UNF-2B	1.00	0.75	2.00	2.50
2,000-2,500	1/2-20 UNF-2B	1.25	1.00	2.00	2.50
3,000	1/2-20 UNF-2B	1.25	1.00	3.00	4.00
5,000-10,000	3/4-16 UNF-2B	1.25	1.00	3.00	4.00
15,000	1-12 UNF-2B	1.50	1.25	4.00	5.50
20,000	1 1/4-12 UNF-2B	2.25	2.00	5.00	7.00
kg/mm					
11.3-136.1	1/4-28 UNF-2B	19.1	12.7	50.8	63.5
226.8-680.4	1/2-20 UNF-2B	25.4	19.1	50.8	63.5
907.2-1,134.0	1/2-20 UNF-2B	31.8	25.4	50.8	63.5
1,360.8	1/2-20 UNF-2B	31.8	25.4	76.2	101.6
2,268.0-4,535.9	3/4-16 UNF-2B	31.8	25.4	76.2	101.6
6,803.9	1-12 UNF-2B	38.1	31.8	101.6	139.7
9,071.9	1 1/4-12 UNF-2B	57.2	50.8	127.0	177.8

RL20000

S-beam, Alloy Steel, NTEP Certified 1:5000 III/1:10,000 IIIL

Order Information

LOAD RATING		PART #	EST. SHIPPING WEIGHT	PRICE
25 lb	(11.3 kg)	21428	2 lb	Consult
50 lb	(22.7 kg)	21429	2 lb	Consult
75 lb	(34.0 kg)	21430	2 lb	Consult
100 lb	(45.4 kg)	21431	2 lb	Consult
150 lb	(68.0 kg)	21432	2 lb	Consult
200 lb	(90.7 kg)	21433	2 lb	Consult
250 lb	(113.4 kg)	21434	2 lb	Consult
300 lb	(136.1 kg)	21435	2 lb	Consult
500 lb	(226.8 kg)	21436	2 lb	Consult
750 lb	(340.2 kg)	21437	2 lb	Consult
1,000 lb	(453.6 kg)	21438	2 lb	Consult
1,500 lb	(680.4 kg)	21439	2 lb	Consult
2,000 lb***	35 ft cable	21356	2 lb	Consult
2,000 lb	(907.2 kg)	21440	2 lb	Consult
2,500 lb	(1,134.0 kg)	21441	2 lb	Consult
3,000 lb	(1,360.8 kg)	21442	4 lb	Consult
5,000 lb***	30 ft cable	17044	4 lb	Consult
5,000 lb	(2,268.0 kg)	21443	4 lb	Consult
10,000 lb	(4,535.9 kg)	21444	4 lb	Consult
15,000 lb	(6,803.9 kg)	21445	7 lb	Consult
20,000 lb***	30 ft cable	17045	17 lb	Consult
20,000 lb	(9,071.9 kg)	21446	17 lb	Consult
Conduit Adapter Kit*(must be factory installed to maintain warranty)				
3/8-24 nipple		31533*	1 lb	Consult
3/8-24 to 1/4-18 NPT		31534*	1 lb	Consult
Replacement Agriculture Scale Load Cell - 40 ft Cable				
10,000 lb	(4,535.9 kg)	151746	5 lb	Consult

*PN 1533 and PN 31534 must be installed together to form the Conduit Adapter Kit

***These load cells have 30 ft of cable and trimmed outputs and are used in many batch plants

Interchangeable Products

MANUFACTURER	MODEL
Artech®	20210**

**15,000 lb thread is 1-14 UNF

Weigh Module Available

MANUFACTURER	MODEL	PAGE #
Rice Lake Weighing Systems	ITCM Isolated Tension Cell Mount	46