

## IQ plus® 355

Digital Weight Indicator



### STANDARD FEATURES

- Large .8in (20.3mm) Light Emitting Diode (LED) Display
- Configurable analog to digital measurement rate
- Power for eight 350Ω load cells or 16, 700Ω load cells
- Primary/secondary units configuration: lb, kg, ounces, short tons, metric tons, grams or none
- Nema 4X/IP66 stainless steel washdown enclosure
- Five button operation
- Two independent communication ports: (1) full duplex, (1) unidirectional or active 20mA current loop
- Standardized EDP command sets
- Programmable ticket formats up to two 300-character printouts
- Full front-panel digital calibration and configuration
- Universal mounting stand
- Three-stage digital filtering
- Consecutive transaction numbering
- Two digital inputs

### APPROVALS



### SPECIFICATIONS

#### POWER:

Line voltages: 115 or 230VAC  
 Frequency: 50 or 60Hz  
 Power consumption: 70mA @ 115VAC (8W)  
 35mA @ 230VAC (8W)

#### EXCITATION VOLTAGE:

10VDC, 8 x 350Ω or 16 x 700Ω load cells

#### ANALOG SIGNAL INPUT RANGE:

-0.6mV/V - 4.5mV/V

#### ANALOG SIGNAL SENSITIVITY:

0.3 μV/graduation minimum,  
 1.5 μV/grad recommended

#### RESOLUTION:

Internal resolution: 308,000 internal graduations  
 Display resolution: 100,000 displayed graduations

#### MEASUREMENT RATE:

30, 15, 7 1/2, 3 3/4 per second

#### SYSTEM LINEARITY:

Within 0.01% of full scale

#### DIGITAL INPUTS:

2 inputs with 8 functions to select from

#### CIRCUIT PROTECTION:

ESD, EMI, RFI protection

#### SERIAL OUTPUT:

EDP port: Full duplex RS-232  
 Printer port: Output-only RS-232 or active 20mA current loop  
 Both ports: 9600, 4800, 2400, 1200, 600, 300 bps; 7 or 8 data bits; even, odd or no parity

#### DISPLAY:

0.8in (20mm), 6-digit Super Red Light Emitting Diode (LED) display, 7-segment, digits

#### STATUS ANNUNCIATORS:

Designators for: center of zero, stand still, gross, net center of zero, standstill, lb, kg, oz, g

#### KEYBOARD:

5-key flat membrane panel, tactile feel

#### OPERATING TEMPERATURE:

(Legal) -10°C to 40°C/14°F to 104°F  
 (Industrial) -10°C to 50°C/14°F to 122°F

#### WEIGHT:

6.4lb (2.9kg)

#### RATING/MATERIAL:

Enclosure: NEMA 4X/IP66, heavy gauge stainless steel

#### APPROVALS:

NTEP - at 10,000 Divisions, Class III/IIIL, CC# 97-130, A2,  
 Measurement Canada approved, AM-5213, Class III/IIILD at 10,000 Divisions  
 OIML approved, TC6008; T5692  
 UL & C-UL listed  
 CE marked

#### WARRANTY:

Two-year limited warranty

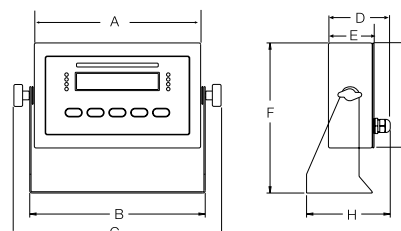

DIMENSIONS			
<b>A</b>	9.50 in (241.3mm)	<b>E</b>	2.75 in (69.9mm)
<b>B</b>	10.02 in (254.5mm)	<b>F</b>	8.57 in (217.7mm)
<b>C</b>	11.80 in (299.7mm)	<b>G</b>	6.00 in (152.4mm)
<b>D</b>	3.67 in (93.2mm)	<b>H</b>	3.85 in (97.8mm)