

SLS14 Single Point Load Cell Stainless Steel

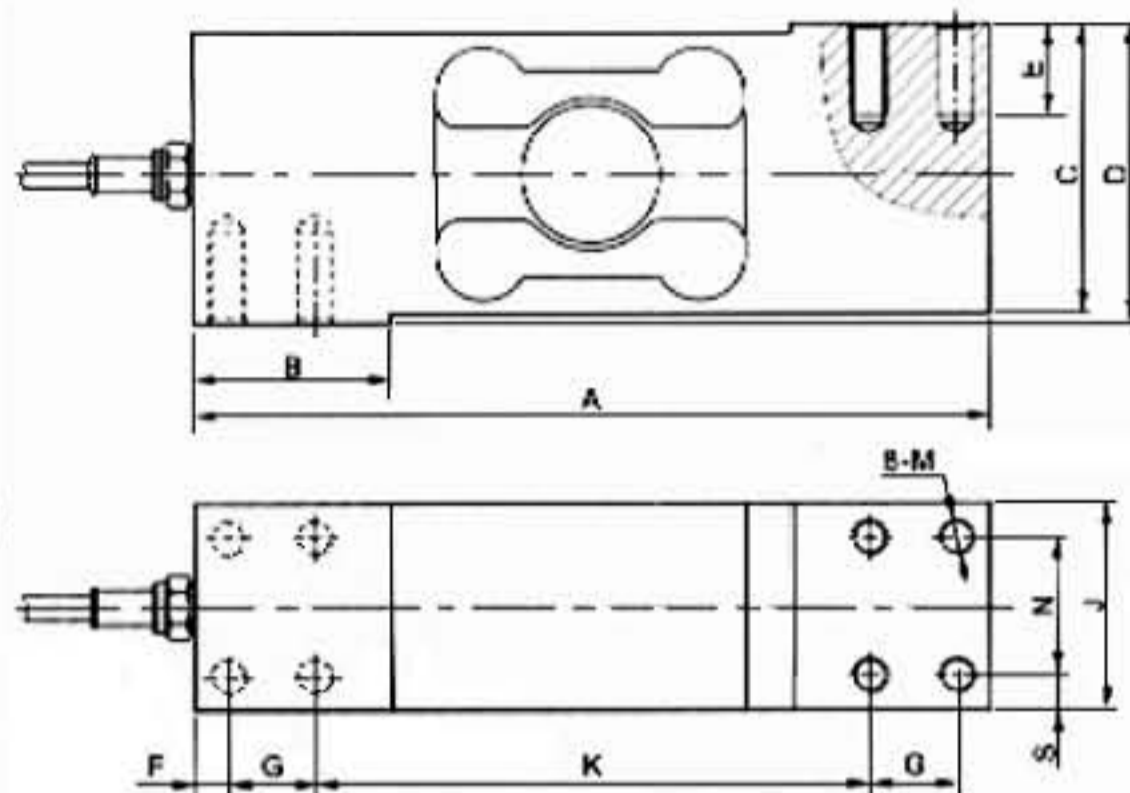
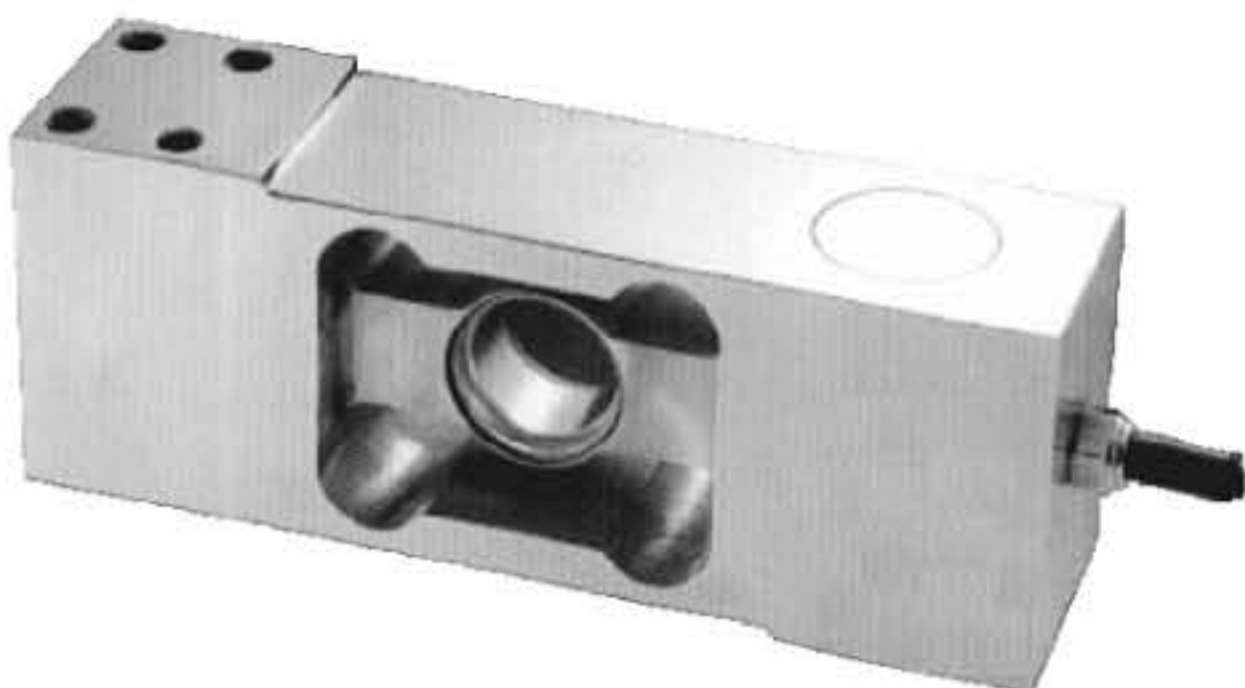

SPECIFICATIONS:

Rated Output	3 ± 0.010 mV/V FS
Nonlinearity	±0.03% FS
Hysteresis	±0.03% FS
Repeatability	±0.01% FS
Creep	±0.02% FS/30min
Zero Balance	±1% FS
Temperature Effect On Zero	±0.02% FS/10°C
Temperature Effect On Rated Output	±0.02% FS/10°C
Input Resistance	385 ± 10 Ω
Output Resistance	350 ± 3 Ω
Insulation Resistance	≥ 5000M Ω
Excitation Voltage	10(Recommended), 15(Max)VDC/AC
Compensated Temperature Range	-10 to +50°C
Operating Temperature Range	-20 to +60°C
Safe Overload	120% FS
Ultimate Overload	250% FS
Protection Class	IP 67
Cable Length	9.8'/3m
Cable Color Code	Red +Excitation, Black -Excitation, Green +Signal, White -Signal

DIMENSIONS:

Capacity	mm											
	A	B	C	D	E	F	G	K	M	N	J	S
kg												
100~750	173.0	43.0	63.0	65.0	20.0	7.25	19.0	120.5	M8	30.0	45	7.5

Dimensions and specifications are subject to change without notice.



<http://www.sensolink.com> E-mail: sales@sensolink.com