

SLPB Single Ended Load Cell

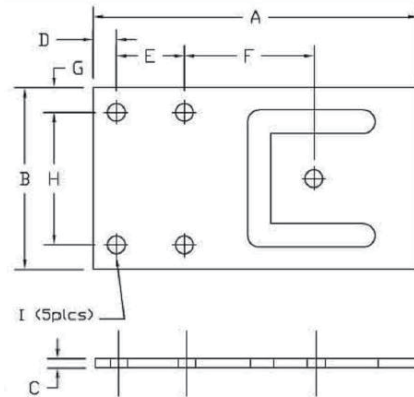
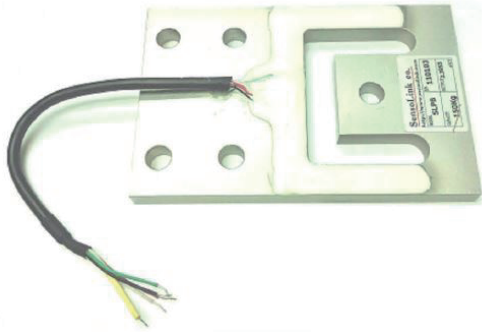

SPECIFICATIONS

Rated Output	2.4±0.2mV/V FS	Temperature Shift On Zero	±0.02% FS/10°C
Nonlinearity	±0.02% FS	Temperature Shift On Rated Output	±0.02% FS/10°C
Hysteresis	±0.02% FS	Excitation Voltage-VDC MAX	15V
Repeatability	±0.01% FS	Compensated Temperature Range	-10 to +40 °C
Creep	±0.02% FS/30min	Operating Temperature Range	-20 to +60 °C
Zero Balance	±1% FS	Safe Overload	150% FS
Input Resistance	1150±15Ω	Ultimate Overload	300% FS
Output Resistance	1000±3Ω	Protection Class	IP65
Insulation Resistance	≥5000MΩ	Cable Length	90mm
Material	Aluminum		
Cable Color Code	Green +Excitation, Black -Excitation, White +Signal, Red -Signal		

DIMENSIONS

inch

Capacities	A	B	C	D	E	F	G	H	I
kg									
3.75~15	2.75	1.53	0.078	0.196	0.57	1.09	0.22	1.09	0.16
37.5	3.00	1.75	0.188	0.236	0.59	1.15	0.28	1.18	0.26
75	3.32	2.15	0.25	0.25	0.59	1.33	0.48	1.18	0.26
150	4.22	2.75	0.31	0.31	0.90	1.80	0.50	1.75	0.32
375	4.70	2.99	0.50	0.036	1.00	2.07	0.50	2.00	0.38

Dimensions and specifications are subject to change without notice.



San Diego, CA USA

<http://www.sensolink.com>

E-mail: sales@sensolink.com