



Dimensions

Picture is a representation of actual product

Rated Capacity	A	B	C	D	E
lb/in					
50*-300	1/4-28 UNF-2B	0.65	0.46	2.00	2.40
500-1,500	1/2-20 UNF-2B	0.90	0.71	2.00	2.40
2,000-2,500	1/2-20 UNF-2B	1.13	0.96	2.00	2.40
3,000	1/2-20 UNF-2B	1.13	0.96	3.00	3.90
5,000	3/4-16 UNF-2B	1.15	0.96	3.00	3.90
10,000	3/4-16 UNF-2B	1.40	1.21	2.94	3.90
15,000*	1-14 UNS-2B	1.63	1.46	3.44	5.50
20,000*	1 1/4-12 UNF-2B	1.88	1.68	4.44	7.00
kg/mm					
22.7-136.1	1/4-28 UNF-2B	16.5	11.7	50.8	61.0
226.8-680.4	1/2-20 UNF-2B	22.9	18.0	50.8	61.0
907.2	1/2-20 UNF-2B	29.2	24.4	50.8	61.0
1,360.8	1/2-20 UNF-2B	29.2	24.4	76.2	99.1
2,268.0-4,535.9	3/4-16 UNF-2B	35.6	30.7	76.2	99.1
6,803.9	1-14 UNS-2B	41.4	37.1	87.4	139.7
9,071.9	1 1/4-12 UNF-2B	47.8	42.9	112.8	177.8

* 50, 15,000 and 20,000 lb capacities are non-NTEP Certified

Order Information

Load Rating		Part #	Est. Weight	Price
100 lb	45.4 kg	31317	2 lb	Consult
200 lb	90.7 kg	31316	2 lb	Consult
300 lb	136.1 kg	31315	2 lb	Consult
500 lb	226.8 kg	31314	2 lb	Consult
750 lb	340.2 kg	31313	2 lb	Consult
1,000 lb	453.6 kg	31312	2 lb	Consult
1,500 lb	680.4 kg	31311	2 lb	Consult
2,000 lb	907.2 kg	31310	2 lb	Consult
2,500 lb	1,134.0 kg	98875	3 lb	Consult
3,000 lb	1,360.8 kg	31309	4 lb	Consult
5,000 lb	2,268.0 kg	31318	4 lb	Consult
10,000 lb	4,535.9 kg	31308	4 lb	Consult
Non-NTEP Certified				
50 lb	22.7 kg	17076	2 lb	Consult
15,000 lb	6,804.0 kg	165260	7 lb	Consult
20,000 lb	9,072.0 kg	165261	13 lb	Consult

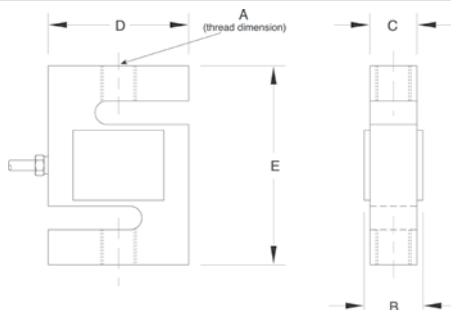

Interchangeable Products

- RICE LAKE WEIGHING SYSTEMS
RL2000SS page 119
- RICE LAKE WEIGHING SYSTEMS
RL2000ST page 120

Weigh Module Available

- RICE LAKE WEIGHING SYSTEMS
ITCM Isolated Tension Cell Mount page 44

Specifications

- Full Scale Output:**
3.0 mV/V ± .0008
- Output Resistance:**
350 (± 3.5) ohms
- Input Resistance:**
390 (± 15) ohms
- Material/Finish:**
Stainless steel
- Temperature:**
Compensated range
14°F to 104°F (-10°C to 40°C)
Operating range
-40° F to 150° F (-40° C to 65° C)
- Manufacturer Model Number:**
9363-B10-XX-20T1 (NTEP Certified)
9363-D3-XX-20T1 (Non-NTEP Certified)
- Safe Overload:**
150% full scale
- Rated Excitation:**
5-10 VDC (15 V maximum)
- Combined Error:**
0.025% full scale
- Non-repeatability:**
0.01% full scale
- Insulation Resistance:**
5,000 megohms
- Seal Type:**
Environmentally sealed, IP67
- Cable Length:**
20 ft/6.1 m
- Cable Color Code:**
Red + Excitation
Black - Excitation
Green + Signal
White - Signal
Transparent Shield
- Warranty:**
One-year limited warranty

Approvals:

